

DEC 22 1943

ERECTING INSTRUCTIONS

AND PARTS-PRICE LIST FOR

David Bradley
WINDMILLS

Model Numbers

802.6 6½ Foot

802.8 8 Foot

802.10 10 Foot

The Model Number of your windmill will be found on a name plate attached to the main frame or oil reservoir casting. Always supply the Model Number when communicating with us regarding your windmill or when ordering repairs.

Good News!

Your DAVID BRADLEY windmill can bring you a new day of comfort and ease. Do you realize that windmills just like your own David Bradley are the "backbone" of inexpensive, drudgery-relieving running water systems all over the country?

We can furnish plans and equipment necessary to give you running water "on tap" at all times!

We will be glad to help you draw up plans for a running water system that will fit YOUR farm. See us immediately. It can mean a new life for you and your family.

SEARS ROEBUCK AND CO.

PARTS-PRICE LIST FOR 8 FOOT MILL MODEL 802.8

Symbol & Part No.	Page Shown	Description	Weight	Price
WC-54A	9	Piston Rod, 9/16 x 50 U.H., Furnished with 9/16 Hex. Nut.	4 lbs. 4 ozs.	\$.75
WC-54½	7	Piston Swivel Eye Plate, 1/2 x 1½ x 1-3/4, See WC-16	2 lbs.	1.20; 46
WC-55	7	Vane Hinge Pin, 9/16 x 14½, Furnished with Cotters .	1 lb.	.25
WC-56	7	Brake Rod, 1/2 x 11½, Furnished with Cotter and Nut.	12 ozs.	.45
WC-58	7	Sheave Pin (Drilled) RH Rivet, 3/8 x 2, Furnished with Cotter	1 oz.	.06
WC-59	7	Sheave Pin (Not Drilled), 3/8 x 2-1/8.	1 oz.	.04
WC-60	7	Latch Pitman, 1/2 x 6" C.C., Furnished with Cotters.	10 ozs.	.25
WC-63A	9	Vane Stem Angle for One Piece Vane Sheet, 1½ x 2 x 6'4" - Painted.	9 lbs. 2 ozs.	2.10
WC-64A	9	Vane Stem Truss Angle, 1½ x 2 x 6'4"	7 lbs. 10 ozs.	2.20
WC-68	9	Wheel Spoke, Furnished with Knee - Formerly E-68 . .	3 lbs. 12 ozs.	.90
WC-69	9	Outer Rim (5 Section Wheel) 1 x 3/16 x 49½	2 lbs. 7 ozs.	.70
WC-70	9	Inner Rim (5 Section Wheel) 1 x 5/32 x 25"	1 lb.	.30
WC-71	9	Sail, #21 Gauge, 13½ x 5½ x 29", Furnished with Clips	3 lbs.	.70
WC-72A	9	Vane Sheet (1 piece), 24" x 48" - Formerly WB-272. . .	8 lbs. 4 ozs.	3.00
WC-74	8	Sail Clip - Large #18 Gauge U.S. - Formerly E-74 . .	3 ozs.	.10
WC-75	8	Sail Clip - Small - each Formerly E-75	1 oz.	.06
WC-76	7	Oil Collar, #12 Wire - 1-1/8 I.D. x 5/8"	1 oz.	.15
WC-78	8	Lower Chain Extension, ¾ x 1 x 4½" long.	6 ozs.	.15
WC-79A	9	Swivel Ball, 3/16 x 5/8 x 15½ x 6-5/8 wide Formerly WC-279.	1 lb. 6 ozs.	1.00
WC-80	8	Upper Chain End, 3/16 x 1 x 3½	3 ozs.	.06
WC-82	8	Governor Spring, 1-11/16 dia. x 14-3/8" long, 74 Coils	2 lbs. 12 ozs.	.90
WC-83	7	Brake Spring, 29/32 dia. x 2-7/8 long.	4 ozs.	.15
WC-85A	8	Swivel Chain, 3/16" x 44-5/8" long	1 lb. 2 ozs.	.90
WC-86A	9	Mill Pipe, 2" Gas Pipe 31½" long, Formerly WC-286. .	9 lbs. 4 ozs.	2.10
WC-89	7	Ball Spacers per set of 15, 5/8" G.P. x 25/32, Furnished with 15 Balls, Formerly WC-289.	1 lb. 2 ozs.	1.70
WC-95	7	Steel Balls per set of 15, 5/8", Furnished with 15 Spacers	1 lb. 2 ozs.	1.70
WC-97	7	Woodruff Key, 5/16 x 1-3/8	1 oz.	.08

PARTS

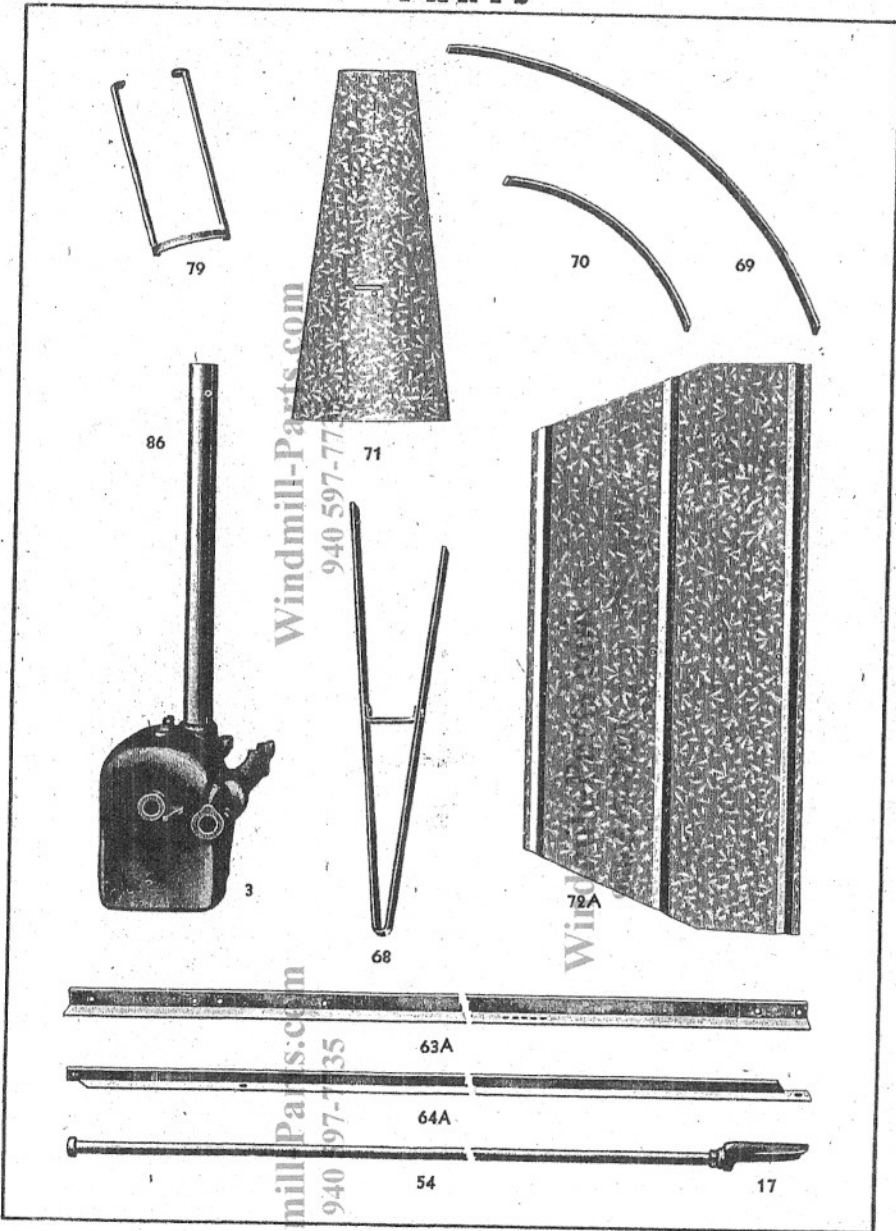

Windmill-Parts.com
940 597-7735

Windmill-Parts.com
940 597-7735

Windmill-Parts.com
940 597-7735

Windmill-Parts.com
940 597-7735

PARTS-PRICE LIST FOR 8 FOOT MILL MODEL 802.8

- Revised March 1, 1943

In ordering Repair Parts, be sure to give Name and Part No.

Symbol & Part No.	Page Shown	Description	Weight	Price
WC-1A	8	Lower Ball Race - Formerly WC-201.	5 lbs. 6 ozs.	\$ 2.00
WC-1X	not shown	Lower Ball Race (3 Post)	5 lbs. 12 ozs.	2.15
WC-2A	8	Lower Tower Casting (4 Post), Furnished with Grease Cup - Formerly WC-202	6 lbs. 14 ozs.	1.50
WC-2X	not shown	Lower Tower Casting (3 Post), Furnished with Grease Cup - Formerly WC-202-3	5 lbs. 8 ozs.	1.90
WC-3A	9	Crank Case, Furnished with Drain & Fill Plugs, Set Screw, Bushings, & Pipe - Formerly WC-203	75 lbs. 6 ozs.	22.00
WC-4	7	Sheave Shield, Furnished with Sheaves, Rivets and Cotter complete - Formerly AC4A	3 lbs. 8 ozs.	1.80
WC-5A	8	Upper Ball Race, Formerly WC-205	7 lbs. 8 ozs.	3.30
WC-6	7	Wheel Shaft Bushing - Long, 1-1/8 x 3-7/8" Formerly K-6	6 ozs.	.35
WC-6 1/2	7	Wheel Shaft Bushing - Short, 1-1/8 x 2-1/8"	3 ozs.	.20
WC-7	8	Pitman Guide	4 lbs. 4 ozs.	1.40
WC-8	8	Crank Gear, 1-3/4 F. 7-13/16" O.D. 6 P.-42 T.	7 lbs. 8 ozs.	2.50
WC-9	7	Pinion, 1-7/8" F. 3" O.D. 6P.-16T.	2 lbs. 5 ozs.	1.20
WC-10V	8	Wheel Hub, Furnished with Shaft, Key, Oil Collar, Cotter, and Washer.	18 lbs. 4 ozs.	7.00
WC-11	7	Upper Vane Hinge, Formerly AC-11	1 lb.	.25
WC-12	8	Lower Vane Hinge, Formerly AC-12	4 lbs.	.80
WC-13	8	Latch.	14 ozs.	.25
WC-14	7	Sheave - Formerly E-14	8 ozs.	.30
WC-15	8	Brake.	3 lbs. 2 ozs.	.75
WC-16	7	Piston Swivel Eye, Furnished with Plate & 2 Bolts 3/8" x 2-3/4"	1 lb. 10 ozs.	1.20
WC-17	9	Upper Pump Pole Casting.	1 lb. 4 ozs.	.40
WC-18	7	Inner Control Wire Swivel - Formerly AC-18	8 ozs.	.40
WC-19	8	Outer Control Wire Swivel, Assembled with 2 bolts and WC-79A.	2 lbs. 4 ozs.	1.80
WC-21	8	Crank Case Cover, Furnished with Gasket.	7 lbs. 4 ozs.	1.50
WC-22	7	Lower Piston Rod Guide, Furnished with 3/8 x 1/2" bolt, less nut - Formerly WC-222.	1 lb. 12 ozs.	.50
WC-42	not shown	Oil Ring Assembly, Furnished with Bracket, Guide & Oil Ring.	8 ozs.	.90
WC-43	7	Oil Ring, #10 x 6" O.D.	2 ozs.	.20
WC-44	7	Oil Ring Guide, Furnished with Bracket, Com.	6 ozs.	.30
WC-46	7	Oil Ring Trough, Furnished complete with Spout	4 ozs.	.20
WC-49	7	Cover Gasket	1 oz.	.15
WC-50	8	Wheel Shaft, 1-1/8 x 14-3/8, Furnished with Hub, Key & Oil Collar.	18 lbs. 10 ozs.	7.00
WC-51	7	Crank Gear Shaft, 1-1/8 x 7"	2 lbs.	.60
WC-52	7	Pitman Guide Hinge Pin, 3/4 x 7/8, Furnished with Cotter Pins	14 ozs.	.35
WC-53	8	Pitman, 1" x 8 C.C.	3 lbs. 13 ozs.	1.30

Windmill-Parts.com
940 597-7735

Windmill-Parts.com
940 597-7735

PARTS

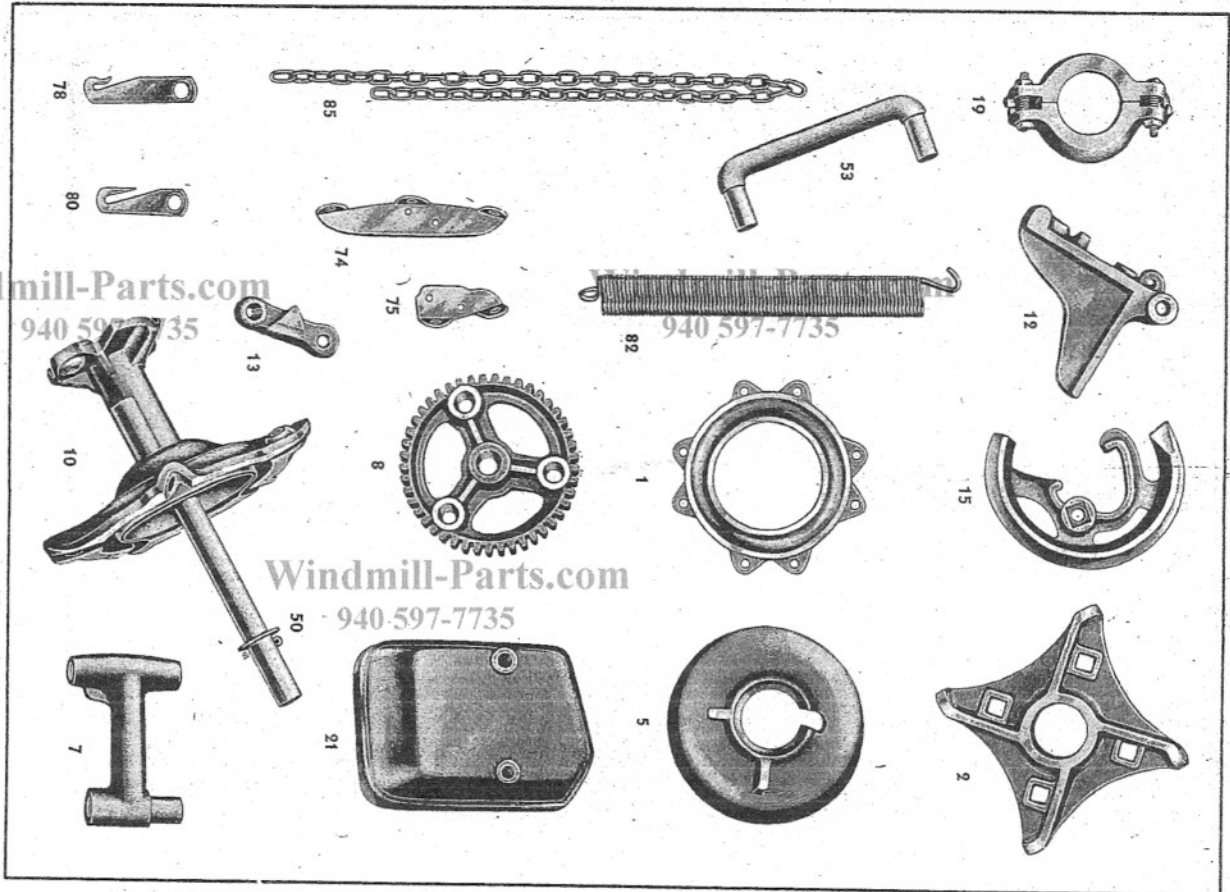

Windmill-Parts.com
940 597-7735

Windmill-Parts.com
940 597-7735

940 597-7735

Windmill-Parts.com
940 597-7735

Windmill-Parts.com
940 597-7735

PARTS

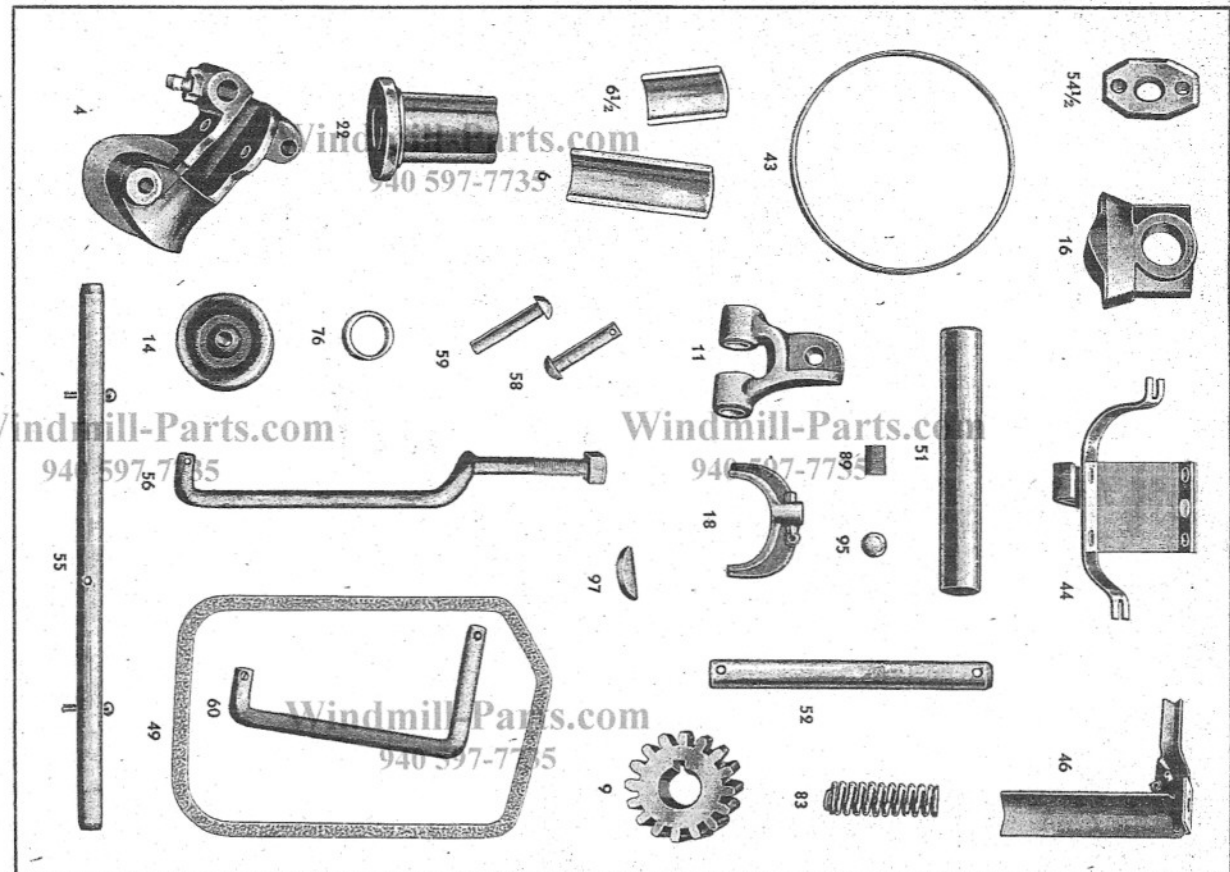

Windmill-Parts.com
940 597-7735

Windmill-Parts.com
940 597-7735

Windmill-Parts.com
940 597-7735