

REPAIR PARTS—Elgin Wonder Model A

Windmill-Parts.com

For Parts List See Page 74

Windmill-Parts.com

940 597-7735

940 597-7735

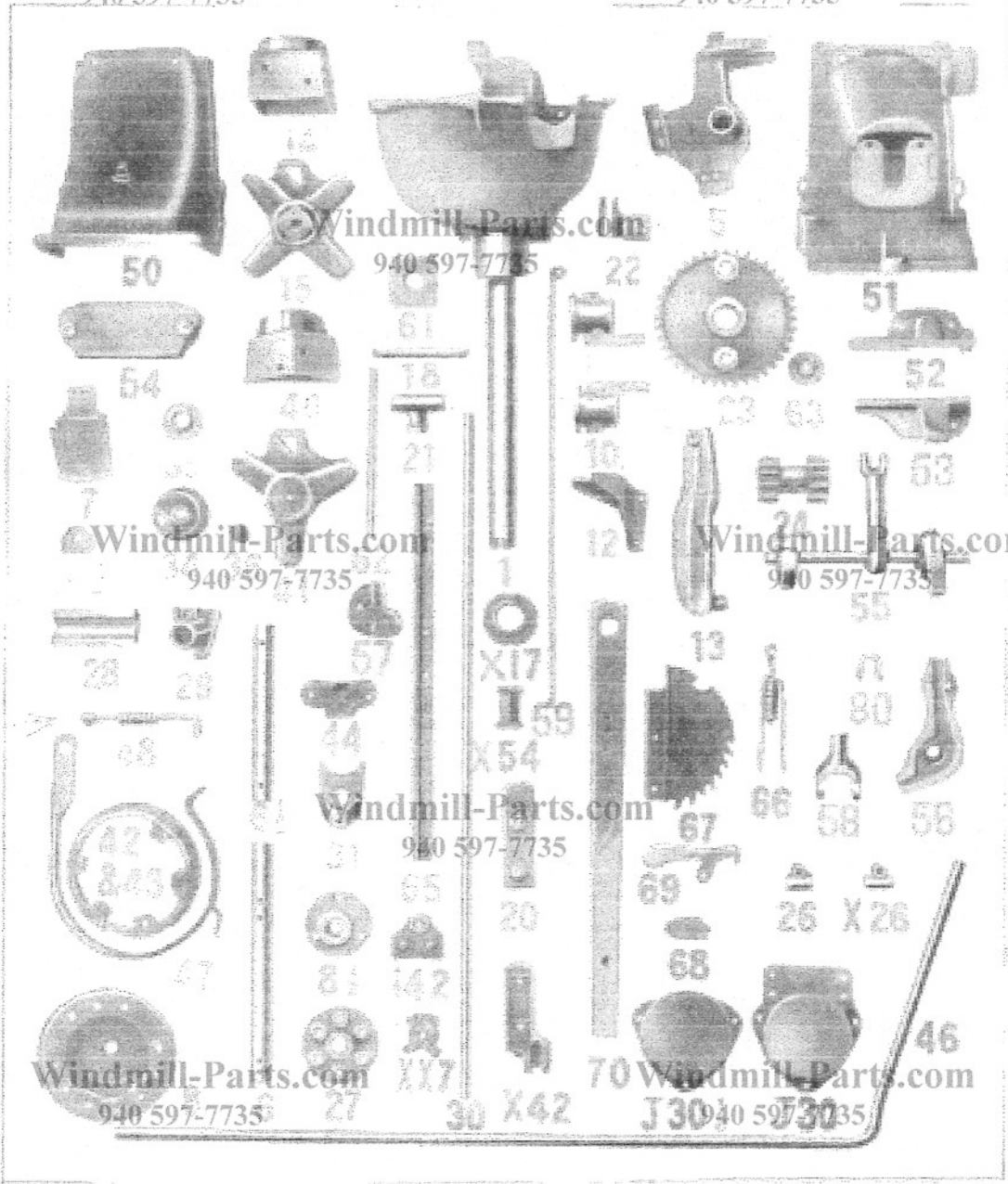

NOTICE

Prevent mistakes. Order by letter and number of part desired. If your Elgin windmill has parts with letters not shown in this catalogue, describe the mill and tell us the letter and we will send correct list covering parts.

Windmill-Parts.com

940 597-7735

REPAIR LIST FOR 8, 10 and 12-ft. WONDER MILL MODEL A

NOTICE: When ordering be sure to state size of mill		No. of Part	8-ft. Letter D	10-ft. Letter J	12-ft. Letter S
940 597-7735					
Main Casting		1	\$ 8.00	\$12.00	\$16.00
Center Piece in main casting		5	1.70	2.50	3.40
Main Shaft		6	1.80	2.70	3.60
Cap over main shaft bearing No. 28		7	.60	.90	1.20
Hub of windwheel		8	1.60	2.40	3.20
Flange on No. 8 for brake band, in 1 piece		9	.80	1.20	1.60
Shifting Shoe, left		10	.40	.60	.80
Shifting Shoe, right		11	.40	.60	.80
Swivel Casting over Nos. 10 and 11		12	.50	.70	1.00
Pitmans, each		13	1.40	2.10	2.80
Tower Cap, 4-post		14	1.40	2.10	2.80
Tower Step, 4-post		15	1.40	2.10	2.80
Wood rod Coupling		20	.50	.70	1.00
Upper Casting for No. 30		21	.30	.40	.60
Vane Support on No. 1		22	.60	.90	1.20
Main Gears, each		23	1.80	2.70	3.60
Double Pinion		24	1.40	2.10	2.80
Nose Piece		27	.90	1.30	1.80
Bearing for main shaft, front		28	.50	.70	1.00
Bearing for main shaft, rear		29	.80	.90	1.20
Plunger rod		30	.60	.90	1.20
Stop to hold No. 1 from raising		31	.30	.40	.60
Ball Plate, lower, Box Metal		34	.90	1.30	1.80
Ball Plate, upper, Box Metal		35	.60	.90	1.20
Cover over ball bearing		36	.60	.90	1.20
Balls for turn table, tempered steel, each			.10	.10	.10
Tower Cap, 3-post		40	1.40	2.10	2.80
Tower Step, 3-post		41	1.40	2.10	2.80
Larger part of No. 44		42	.60	.90	1.20
Smaller part of No. 44		43	.50	.70	1.00
Flange on No. 8 for brake band, in 2 parts		44	1.10	1.60	2.20
Swivel Coupling between Nos. 30 and 20		45	.30	.40	.60
Governing weight Bar		46	1.40	2.10	2.80
Brake Band		47	.40	.60	.80
Covering over gears, front		50	3.00	4.50	6.00
Covering over gears, rear		51	3.30	4.90	6.60
Box over No. 55, upper		52	.60	.90	1.20
Box over No. 55, lower		53	.70	1.00	1.40
Cap over Nos. 50 and 51		54	.50	.70	1.00
Rocker Arm		55	1.30	1.90	2.60
Casting which attaches Nos. 46 to 55		56	.30	.40	.60
Guide for No. 65		57	.30	.40	.60
Shifting Rod, connecting with No. 55		59	.40	.60	.80
Wood Blocks which guide No. 30, each		61	.30	.40	.60
Guide Rods over which wood blocks work, each		62	.30	.40	.60
Washers on Main gear hubs, each		63	.20	.20	.40
Tower step for 10 and 12-ft. long stroke mills		64		2.10	2.80
Angle Iron Guide Rod connecting with No. 12		65	.40	.60	.80
Brake and Buffer Spring, each		66	.20	.30	.40
Pump Coupling		88	.80	.40	.60
Main shaft complete with Nos. 27, 8, 9, 24			6.00	9.00	12.00
Plunger rod complete with Nos. 21, 45 and 20			1.50	2.30	3.00
One corner of steel top			2.00	3.00	4.00
Steel Top complete with Nos. 14 and 15			9.00	13.50	18.00
Main Casting complete with all working parts			23.00	34.50	46.00
Main Casting complete with 5-foot stub tower as shipped with mill			30.00	45.00	60.00
VANE FRAME PARTS					
Vane frame (Angle steel)			3.00	4.50	6.00
Rudder (Sheet steel)			3.00	4.50	6.00
Buffer spring rod with spring	60		.50	.70	1.00
Swivel Casting on Vane Frame	25		.20	.30	.40
Swivel Casting on No. 46	26		.20	.30	.40
Swivel Casting between Nos. 25 and 26, each	58		.30	.40	.60
Vane Frame complete as shipped with mill			8.00	12.00	16.00
WINDWHEEL PARTS					
Arms, each			1.40	2.10	2.80
Blades, clips attached, each			.80	1.20	1.60
1 Section complete, 3 blades			3.50	5.30	7.00
Windwheel complete as given above			25.00	35.00	48.00
Windwheel complete as shipped with mill			28.00	40.00	54.00