

Fairbanks-Morse Steel Pumping Windmill

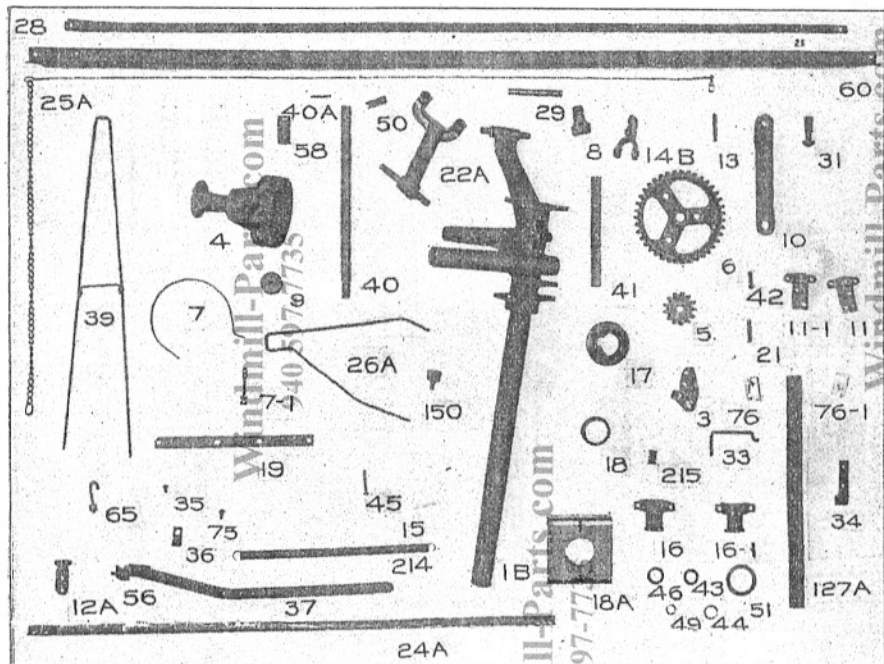

FIG. "AA"
Working Parts of 1905 Model 8-foot and 10-foot Fairbanks-Morse Steel Pumping Mill

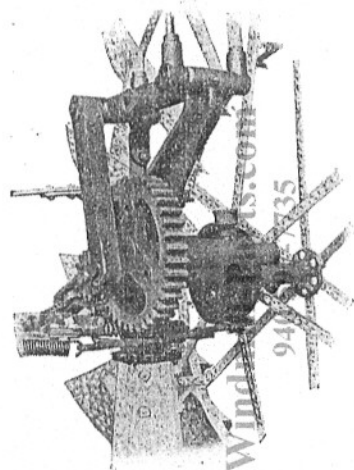

FIG. "BB"

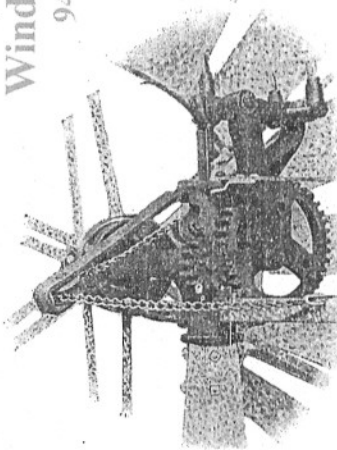

FIG. "CC"

IMPORTANT

Figures "BB" and "CC" show assembled motor. "AA" shows separate parts. In ordering repairs be careful to note the letter preceding number of parts which indicates size of mill. To correctly fill orders for repairs for Fairbanks-Morse Steel Windmills we must have the following information: Diameter of wheel, number and letter on casting, the date purchased. (The "number" on casting indicates piece wanted. The letter indicates the style and size of mill. "WQ" indicates 8-foot Fairbanks-Morse steel mill. "U" indicates Old Style 10-foot steel mill, etc.) Also state whether mill is fitted with plain or graphite bearings. Delay and annoyance may be avoided by giving us this information when ordering; otherwise we shall be obliged to write for it.

Terms on repairs strictly cash, and they will be sent C. O. D. unless cash accompanies the order.

Repair Parts List for 1905 Model Fairbanks-Morse Steel Windmills

DESCRIPTION OF PARTS	Repair No.	8-FT. MILL Symbol	10-FT. MILL Symbol	12-FT. MILL Symbol
Pivot Casting (with sheave, pin and cotter).....	1B	W Q 1D	WS 1B	WU 11
Vane Hinge.....	3	W Q 3A	WS 3	WU 3
Spider (with key).....	4	W Q 4	WS 4	WU 4
Pinion.....	5	W Q 5	WS 5	WU 5
Gear Wheel, pressed on to Gear Shaft.....	6	W Q 6	WS 6	WU 6
Brake Band.....	7	W Q 7	WS 7	WU 41
Brake Band Eyebolt.....	7-1	W Q 37	W Q 37	WU 7
Brake Band, with Eyebolt attached (7 and 7-1).....				WU 37
Upper Pitman Eye.....	8	W Q 8	WS 8	WU 8
Sheave.....	9	T 9	U 9	A 20
Pitman (wooden).....	10	W Q 10	WS 10	WU 10
Swivel for Pump Pole (Right).....	11	W Q 11	WS 11	WU 11
Swivel for Pump Pole (Left).....	11-1	W Q 11-1	WS 11-1	WU 11-1
Swivel, complete (11 and 11-1, with Bolts).....				
Swivel End for Piston Rod (with Rivets).....	12A	W Q 12A	WS 12A	WU 12
Upper Pitman Eye Pin.....	13	W Q 13	WS 13	WU 13
Upper Pitman Fork.....	14B	W Q 14B	WS 14B	WU 14
Upper Rod (comprising Nos. 8, 13 and 14B).....				
Governor Spring Eyebolt.....	15	W Q 15	W Q 15	WU 15
Lower Guide Cap (Right).....	16	WS 16	WS 16	WU 16
Lower Guide Cap (Left).....	16-1	WS 16-1	WS 16-1	WU 16-1
Lower Guide Cap (with Bolts, complete).....				
Collar for Wood or Steel Tower.....	17	W O 17	W O 17	WU 17
Step Bushing for Wood or Steel Tower.....	18	W O 18	W O 18	WU 18
Step for Wood or Steel Tower.....	18A	W O 18A	W O 18A	WU 18
Brake Lever.....	19	W Q 19	WS 19	WU 19
Lower Vane Hinge Pin.....	21	W Q 21	WS 21	WU 21
Rocker Arm, with Pin cast in.....	22A	W Q 22A	WS 22A	WU 22
Piston Rod (angle steel).....	24A	W Q 24A	WS 24A	WU 24
Piston Rod, complete with Fork and Swivel.....				
Pull-out Chain, with Rod and Swivel.....	25A	WS 25A	WS 25A	WU 25
Sheave Arm, with Rivets, no Sheave.....	26A	W Q 26A	WS 26A	WU 26
Vane Blade, only.....	27	W Q 27	WS 27	WU 27
Vane Brace, with Clip.....	28	W Q 28	WS 28	WU 28
Hinge Pin for Rocker Arm.....	29	W Q 29	WS 29	WU 29
Wrist Pin, with Nut, Collar and Washer.....	31	W K 31	WS 31	WU 31
Brake Link.....	33	W Q 33	WS 33	WU 33
Pump Connection.....	34	W H 34	W H 34	WU 34
Brake Band End Rivets.....	35	W Q 35	W Q 35	WU 35
Brake End (attached to Brake Lever).....	36	W Q 36	WS 36	WU 36
Out Gear Lever.....	37	T 37	T 37	
Out Gear Reel.....	61			W C 61
Out Gear Wire.....				
Wheel Sections (per set of 6).....	39	W Q 39A	WS 39	WU 39
Wheel Arms (per set of 6).....	40	W Q 40	WS 40	WU 40
Main Shaft, with Cotter Pin.....	40A	W Q 40A	WS 40A	WU 40
Main Shaft Pin.....	41	W Q 41	WS 41	WU 41
Gear Shaft (pressed into Gear No. 6).....	42	W Q 42	WS 42	WU 42
Upper Vane Hinge Pin.....	43	W H 43	WS 43	WU 43
Wrist Pin Washers (2) each.....	44	W Q 46	WS 44	WU 44
Gear Shaft Washers (2) each.....	45	WS 45	WS 45	WU 47
Sheave Pin.....	46	W Q 46	WS 46	WU 46
Pivot Shaft Washers (6).....	48		WS 48	WU 48
Rocker Arm Pin Washers (2).....	49	W Q 49		WU 49
Rocker Arm Pin Washers (2).....	50	W Q 50	WS 50	WU 50
Grease Cup Plugs.....	51	W Q 51	W Q 51	WU 51
Pivot Washers.....	56	A 56	A 56	
Out Gear Lever End.....	58	W Q 58	WS 58	WU 58
Babbitt Shaft Bearings (6 and 8).....	60	W Q 60	WS 60	WU 60
Angle Steel Vane Bar (Right).....	60-1			WU 60
Angle Steel Vane Bar (Left).....	65	WS 65	WS 65	WU 65
Hook Bolt, with 2 Nuts.....	127A	WM 127A	WM 127A	WU 127
Pump Pole Connection.....				
Grease Cups (Iron).....	150			
Governor Spring.....	214	214	240A	241
Buffer Spring.....	215	215	215	235
Brake Lever Rivets.....	75	W Q 34	W Q 34	WU 34
Sheet Steel Clip, Clamping Pump Rod (Right).....	76	W Q 38	W Q 38	
Sheet Steel Clip, Clamping Pump Rod (Left).....	76-1	W Q 38-1	W Q 38-1	
Wheel Fan (with clip), each.....		T 38	U 38	V W 153
Pump Poles (pair).....	114	A 114	A 114	B 114
Pump Poles, Splices (2).....		A 39	A 39	A 39
Pump Poles, Splice Bolts (4).....				
Swivel Box Bolts.....				
Wheel Bolts (set).....				