

Windmill-Parts.com

940 597-7735

Windmill-Parts.com

940 597-7735

Repair Chart — Fig. 605, Model 9 Star Steel Direct Stroke Windmill

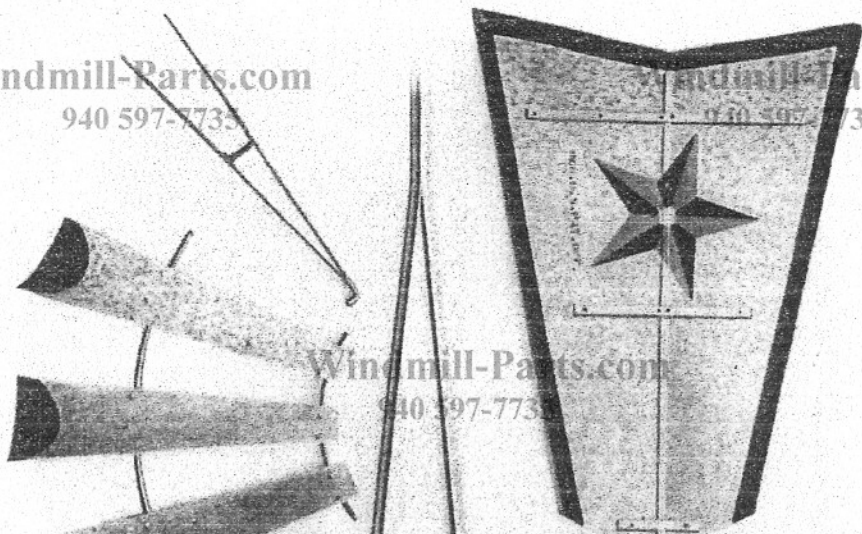

Windmill-Parts.com

940 597-7735

Windmill-Parts.com

940 597-7735

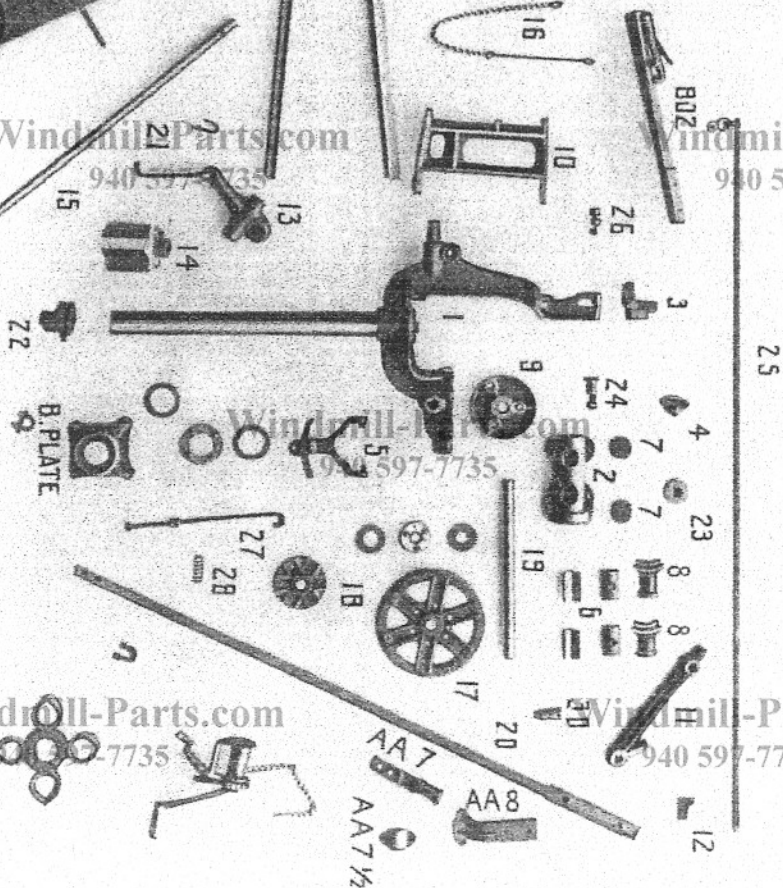

Windmill-Parts.com

940 597-7735

Windmill-Parts.com

940 597-7735

Windmill-Parts.com

940 597-7735

Repair List

Fig. 605

Star Galvanized Steel Direct Stroke Windmill, Model 9

Windmill-Parts.com

This mill not made now, but repairs are furnished as here listed.

No. of Casting	Description of Parts	8-foot Mill	
		Symbol	Price
1	Main Casting, less pipe.....	189	\$ 9.00
..	Main Casting Pipe only.....	1.00
2	Main Casting Cap.....	289	1.20
3	Upper Guide.....	389	.80
4	Sheave Cover.....	489	.15
5	Brake.....	589	.70
6	Ball-Bearing Bushing, each.....	687	.60
7	Oil Cup Covers, each.....	787	.05
8	Non Ball-Bearing Bushing, each.....	887	.75
9	Crank Wheel.....	989	1.60
10	Rudder Casting.....	1089	2.40
11	Pitman with Bushings.....	1189	1.50
12	Babbitt Bushings for Pitman, each.....	1289	.25
13	Shifting Iron, with Hook.....	1389	.80
14	Governor Weight.....	OK24	2.50
15	Governor Pipe.....	1589	.40
16	Governor Chain and Rod.....	1689	.80
17	Inside Spider.....	1787	2.25
18	Outside Spider.....	1887	.75
19	Main Shaft.....	1989	1.20
20	Plunger Rod.....	2089	1.20
21	Rudder Hook.....	2189	.35
22	Bottom Cap.....	2287	.50
23	Sheave.....	2387	.25
24	Wrist Pin.....	2489	.50
25	Shifting Rod.....	A14	.30
26	Bumper.....	2689	.10
27	Brake Rod.....	2789	.30
28	Brake Spring.....	2887	.10
29	Bumper Rubber.....	2989	.10
30	Upper Wrist Pin.....	3089	.40
..	Bed Plate Retainer and Washers.....	2 -in.	1.20
..	Thrust Retainer and Washers.....	1 1/2-in.	.80
..	Upper Swivel Casting.....	2187	.75
..	Swivel Casting Cap.....	AA7 1/2	.15
..	Lower Swivel Casting.....	AA8	.50
..	Swivel complete.....	..	.50
..	Pump Rod, per foot.....	1 1/2-in.	.06
..	Balance Weight.....	AK29	.85
..	Splice Irons and Bolts, per pair.....	..	.30
..	Short Wheel Hoops, each.....	..	.30
..	Long Wheel Hoops, each.....	..	.50
..	Large Fan Bracket, each.....	..	.15
..	Small Fan Bracket, each.....	..	.05
..	Wheel Fan, less brackets, each.....	..	1.00
..	Wheel Arm, each.....	..	1.00
..	Section, less arm.....	..	5.50
..	Complete Sections for Wheel, less arms.....	6	20.00
..	Rudder Stem.....	..	3.50
..	Rudder, less stem.....	..	6.50

For Bed Plates and Truing Spiders, see page 5.

For Reefing Gears and Windmill Coupler, see pages 28, 29.