

PARTS LIST FOR IMPROVED TYPE "J" WINDMILLS

Windmill-Parts.com

SINCE JULY 1, 1935

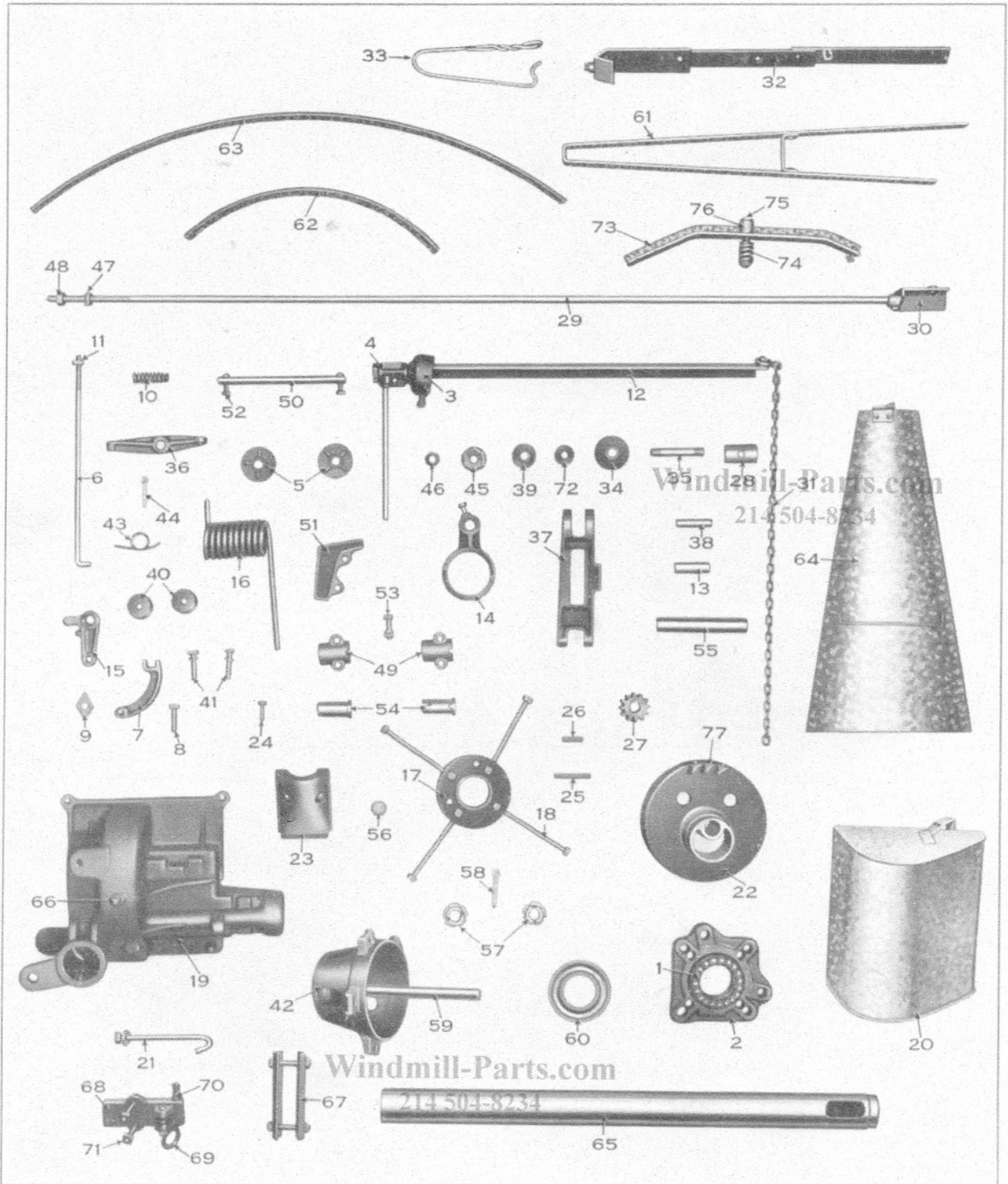

**REPAIR PARTS PRICE LIST FOR TYPE "J"
WOODMANSE WINDMILL**

ERECTED SINCE JULY 1, 1935

Item No.	PART NAME	6 1/2 Ft. B. C.	
		Symbol	Price
1	Ball Bearings	6J17	\$.50
2	Bed Plate	G510	1.50
3	Bottom Plunger Guide	6J19A	.75
4	Pullout Swivel	6J15	1.00
5	Governor Spring Bushing	6E212	.25
6	Brake Rod	6J69	.40
7	Brake Shoe	6J7	.75
8	Brake Shoe Cap Screw	G41	.10
9	Brake Shoe Lock Washer	G42	.10
10	Brake Rod Spring	6J18	.20
11	Brake Rod Nuts	6J11	.10
12	Pullout Pipe	6J12A	1.50
13	Eccentric Pin	6J44	.60
14	Eccentric Ring	6J6C	2.00
15	Front Brake Lever	6J8	.60
16	Governor Spring	8E29	1.50
17	Guide Plate	511	1.25
18	Guide Plate Bolts	G45	.10
19	Head Casting	6J1B	9.50
20	Hood	6J27	2.50
21	Hook Bolt for Governor Spring	8G360	.25
22	Internal Gear	6J5C	5.00
23	Inspection Plate	6J35	.50
24	Inspection Plate Screw	6J46	.10
25	Wheel Shaft Key	6J47	.25
26	Pinion Key	6J48	.15
27	Pinion	6J203	1.00
28	Swivel Pivot Pin	6J22	.75
29	Plunger with Nuts and Wood Rod Connector	6J37	1.25
30	Wood Rod Connector	6J20	.40
31	Pullout Chain	6J30	.50
32	Pullout Lever	6J21	.50
33	Pullout Lever Link	6J23	.25
34	Umbrella Tube	6J39	.30
35	Umbrella Tube	6J25	.30
36	Rear Brake Lever	6J10	.60
37	Rocker Arm	6J4A	2.25
38	Rocker Arm Pin	6J24	.60
39	Swivel Plate	6J26	.50
40	Pulley	G55	.25
41	Pulley Bolt	6J56	.10
42	Spider and Shaft	6J2	3.00
43	Front Brake Lever Tension Spring	6G65	.15
44	Front Brake Lever Cotter Pin	6J28	.05
45	Swivel Top	6J13	.25
46	Swivel Lock Nut	6J31	.10
47	Hexagon Nut for Plunger		.10
48	Hexagon Lock Nut for Plunger		.10
49	Wheel Shaft Bearing Caps	6J9	.40
50	Vane Hinge Pin	6J16	.50
51	Oil Trough	6J34	.45
52	Vane Hinge Pin Lock Bolts	6J32	.10
53	Wheel Shaft Bearing Cap Bolts		.10
54	Wheel Shaft Bearings (4 pieces), set	6J33	1.00
55	Gear Shaft	6J21A	1.25
56	Gear Shaft Lead Disc		.10
57	Wheel Shaft Thrust Collar	6G36	.25
58	Gear Shaft Thrust Collar Cotter	6J42	.05
59	Wheel Shaft	6G1	.25
60	Upper Ball Race Collar	6E12	.60
61	Wheel Arms	6J41	.80
62	Inside Wheel Rim	6J49	.50
63	Outside Wheel Rim	6J50	.60
64	Wheel Fans	269	.75
65	Mast Pipe	6J61	1.00
66	Drain Plug	6G60	.15
67	Rod Coupling and Bolts for Wood Rods	324	.40
68	Pump Slide Casting	G49	.50
69	Pump Slide Pull Pin	G51	.20
70	Pump Slide Pin Spring	G50	.15
71	Pump Slide U-Bolt	G52	.25
72	Swivel Washer	6J52	.10
73	Bumper Bar	6J66	.50
74	Bumper Bar Spring	6J18	.20
75	Bumper Bar Spring Bolt	6J67	.15
76	Bumper Bar Bolt Bushing	6J68	.20
77	Oil Fins for Internal Gear	6J63	.15

Illustration on Opposite Side of Sheet.