

Ref. No.	Part Number	Previous Part No.	Used On & No. Used			Description
			Prior to Late '31	Late 1931 to June '52	June '52 & Later	
1	380 3 0131	1-1344A	*	Sub.	1	Brace Spider — for 5 Section Wheel
1A NI	380 3 0223	1-1344	Sub.	Sub.	1	Brace Spider — for 6 Section Wheel
2	380 3 0130	1343AS	*	1	1	Wheel Spider — for 5 Section Wheel (1) 900 00458 1/2" NF x 2-3/4" Hex Head Bolt (1) 900 10029 1/2" Lockwasher (1) 900 05022 1/2" NF Hex Nut
2A NI	380 3 0174	1343	1	1	1	Wheel Spider for 6 Section Wheel (1) 900 00458 1/2" NF x 2-3/4" Hex Head Bolt (1) 900 10029 1/2" Lockwasher (1) 900 05022 1/2" NF Hex Nut
3	380 2 0011	13118A	N.A.	1	1	Brake Shoe Assembly (1) 900 00052 1/2" NC x 2-3/4" Hex Head Bolt (1) 900 10029 1/2" Lockwasher (1) 900 05020 1/2" NC Hex Nut
4	380 3 0025	1348A	N.A.	1	1	Brake Band Only (2) 900 20006 1/4" x 5/8" oval Head Rivet
5	380 3 0047	01385	N.A.	1	1	Brake Spring
6	380 2 0169	N.A.	(a)	(b)	1	Wheel Shaft Kit — Consists of Items 7 through 19
7	380 3 0120	N-1346	N.A.	(b)	1	Wheel Shaft (2) 900 05090 3/4" NC Slotted Hex-Nut (2) 900 10054 1-1/2" OD x 25/32" ID x #12 Ga. Washer (2) 900 22014 5/32" x 1-1/4" Cotter Key
8	900 24021	1-1368	Sub.	1	1	Key — 3/8" Square x 5" Long
9	380 3 0205	1373	*	*	1	Dust Guard Washer
10	380 3 0135	13131A	*	*	1	Spacer — Between Spider & Bearing
11	907 05020	1372	N.A.	(b)	1	Oil Ring
12	901 02012	1-1389	N.A.	(a)	1	Oil Seal
13	380 2 0170	1-1302A	(a)	(b)	1	End Plate with Oil Seal (3) 900 00020 3/8" NC x 1-3/4" Hex Head Bolt (3) 900 10140 3/8" Lockwasher (3) 900 05011 3/8" NC Hex Nut
14	380 3 0136	1319A	*	*	4	Gasket
15	901 00032	1347A	N.A.	2	2	Bearing — Cup & Cone
15A	901 00034	1931	N.A.	2	2	Bearing Cup Only
15B	901 00033	1905	2	2	2	Bearing Cone Only
16	380 3 0119	1-1303	(a)	(b)	1	Wheel Shaft Spacer
17	900 24028	1377	2	2	2	Key — 3/8" x 1" Long
18	380 3 0121	1376	2	2	2	Pinion
19	380 3 0122	01392	N.A.	2	2	Pinion Spacer
20	380 3 0049	1596A	*	1	1	Bearing Stop Ring
21	380 2 0032	1310	2	2	2	Pitman Assembly — Includes Pin (1) 900 10061 1-1/2" OD x 31/32" ID x #14 Ga. Washer (1) 900 22019 3/16" x 1-1/4" Cotter Pin (1) 900 20053 1/4" x 1-7/8" Wagon Box Rivet
22	380 3 0114	1315	2	2	2	Pitman Pin Only
23	380 3 0116	1375L	1	1	1	Gear — Left
24	380 3 0133	1335	1	1	1	Gear Shaft
25	380 3 0115	1375R	1	1	1	Gear — Right
26	380 3 0134	1311	1	1	1	Gear Shaft — clamp (1) 900 00050 1/2" NC x 2-1/4" Hex Head Bolt (1) 900 05052 1/2" NC Hex Jam Nut (1) 900 00361 3/8" NC x 1-3/4" Square Head Set Screw (1) 900 05011 3/8" NC Hex Nut
27	380 3 0129	1336	1	1	1	Gear Retainer
28	380 3 0137	1350	1	1	1	Guide Rod — Long (1) 900 05027 3/4" NC Hex Nut
29	380 3 0138	01351	Sub.	1	1	Guide Rod — Short (1) 900 05056 3/4" NC Hex Jam Nut
30	380 2 0038	1305	Sub.	1	1	Cross Head
31	380 3 0128	1326	1	1	1	Pump Rod Carrier
32	380 3 0117	1-1330	Sub.	Sub.	1	Guide Rod Spacer (2) 900 00358 3/8" NC x 3/4" Square Head Set Screw (1) 900 00002 3/8" NC x 2-1/4" Hex Head Bolt (1) 900 05012 3/8" NC Hex Nut, Plated (1) 900 05048 3/8" NC Hex Jam Nut
33	380 3 0132	1304	1	1	1	Cross Head Pin
34	380 2 0045	1364	1	1	1	Hood (1) 900 10004 3/8" Flat Washer (1) 900 10129 Leather Washer

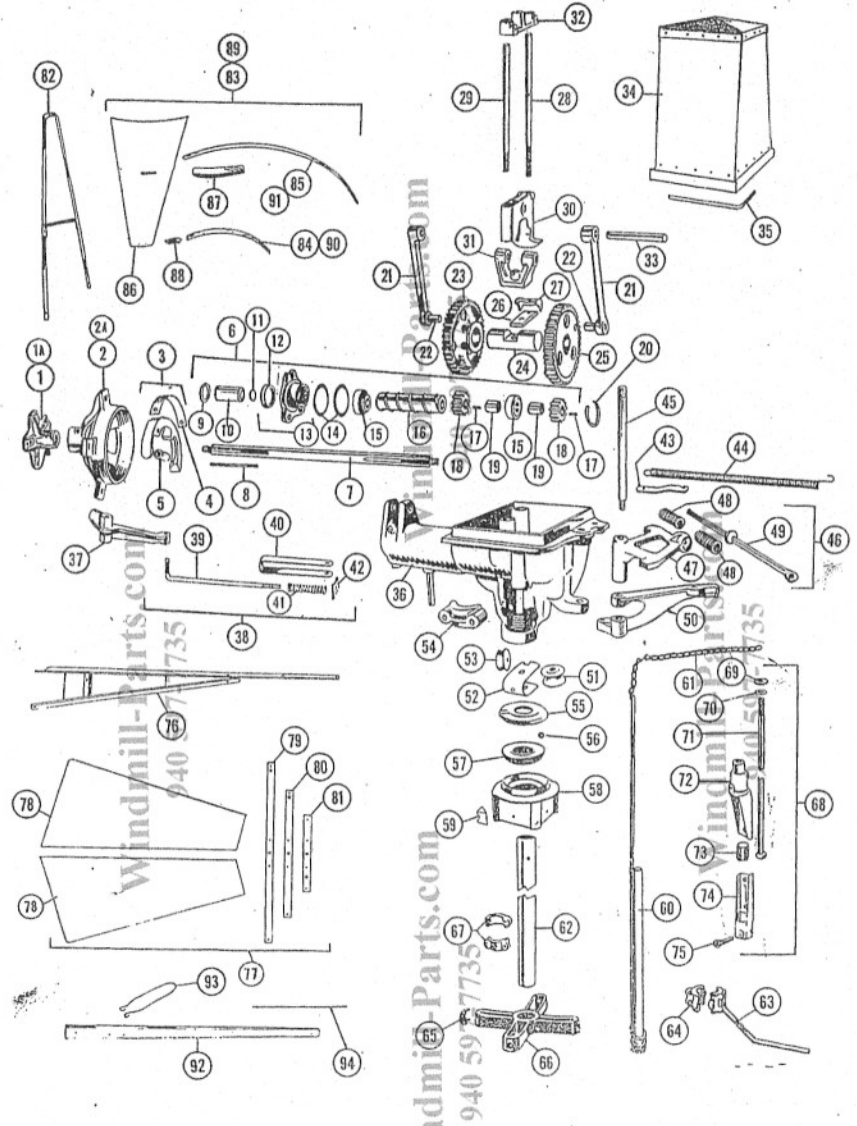

Windmill-Parts.com 940 597-7735

Windmill-Parts.com 940 597-7735

Windmill-Parts.com 940 597-7735

Ref. No.	Part Number	Previous Part No.	Used On & No. Used			Description
			Prior to Late '31	Late 1931 to June '52	June '52 & Later	
68	380 2 0026	01223N	Sub.	1	1	Self Oiling Pump Rod Assembly Consists of Items 69 through 73 (1) 900 22014 5/32" x 1-1/4" Cotter Pin
69	380 3 0078	12105N	*	1	1	Leather Washer
70	900 10050		*	1	1	Washer — 1-1/8" OD x 9/16" ID x 12 Ga.
71	380 3 0077	01223N	Sub. Item 68	1	1	Pump Rod
72	380 3 0076	01260H	Sub. Item 68	1	1	Pump Rod Swivel (1) 900 00358 3/8" NC x 3/4" Set Screw (1) 900 05048 3/8" NC Hex Nut (1) 907 00109 Grease Cup
73	380 3 0075	001259H	Sub. Item 68	1	1	Pump Rod Swivel Nut
74	380 3 0066	A20	1	1	1	Pump Connection
75	380 3 0071	11	1	1	1	Pump Pin (1) 900 22013 5/32" x 1" Cotter Pin
76	380 2 0048	1340	Sub.	Sub. (f)	1	Vane Stem Assembly
77	380 1 0010		1	1	1	Vane Assy — Consists of Items 78 through 81 (4) 900 00017 3/8" NC x 1" Hex Head Bolt, Plated (4) 900 05012 3/8" Lockwasher, Plated (4) 900 10025 3/8" NC Hex Nuts, Plated
78	380 3 0162	1175A	2	2	2	Vane Sheets (13) 900 20035 3/16" x 1/2" Flat Head Rivet
79	380 3 0159	1169A	1	1	1	Long Vane Cross Bar
80	380 3 0160	1170A	1	1	1	Med. Vane Cross Bar
81	380 3 0161	1171A	1	1	1	Short Vane Cross Bar
82	380 2 0049	1142A	6	5 or 6	5 or 6	Wheel Arm Assy — Both 5 & 6 Section Wheels (3) 900 00260 3/8" NC x 1" Carriage Bolt, Plated (3) 900 10025 3/8" Lockwasher, Plated (3) 900 05012 3/8" NC Hex Nut, Plated
83	380 2 0050		5	5	5	Wheel Section — Consists of Items 84 through 88 — for 5 Section Wheel (1) 900 00017 3/8" NC x 1" Hex Head Bolt, Plated (1) 900 00260 3/8" NC x 1" Carriage Bolt, Plated (1) 900 00261 3/8" NC x 1-1/8" Carriage Bolt, Plated (3) 900 10025 3/8" Lockwasher, Plated (3) 900 05012 3/8" NC Hex Nut, Plated
84	380 3 0166	0136A	1	1	1	Wheel Circle Short — 5 Section Wheel (2) 900 20070 #6 F.H. Rivet, Galvanized
85	380 3 0167	0137A	1	1	1	Wheel Circle Long — 5 Section Wheel (2) 900 20035 3/16" x 1/2" F.H. Rivet, Galvanized
86	380 3 0168	0138A	3	3	3	Wheel Fan
87	380 3 0095	154	3	3	3	Wheel Fan Plate (3) 900 20069 #4 F.H. Rivet, Galvanized
88	380 3 0096	155	3	3	3	Wheel Fan Ear (2) 900 20068 #4 F.H. Rivet, Galvanized
89	380 2 0053	6	6	6	6	Wheel Section — Consists of Items 86, 87, 88, 90 and 91 — for 6 Section Wheel
90	380 3 0698	136A	1	1	1	Wheel Circle Short — 6 Section Wheel (2) 900 20070 #6 F.H. Rivet, Galvanized
91	380 3 0696	137A	1	1	1	Wheel Circle Long — 6 Section Wheel (2) 900 20035 3/16" x 1/2" F.H. Rivet, Galvanized
92	380 3 0103	187	1	1	1	Pullout Level
93	380 3 0104	186A	1	1	1	Pullout Level Nail (1) 900 00024 3/8" NC x 2-3/4" Hex Head Bolt (1) 900 05011 3/8" NC Hex Nut
94	380 3 0097	467	1	1	1	Pullout Wire — #0" 59

NOTES:

- (a) Not illustrated
- (b) Referenced part not available for this model year & earlier.
- (c) Will interchange entirely or with slight remark.
- (d) Not used.
- (e) Suggest ordering complete engine from Windmill Price Sheet.
- (f) Order Wheel Shaft Kit #380 2-0169 and the applicable Price Spider to convert to present production.
- (g) If other numbers appear on either race order item items 85 & 87
- (h) If pullout tube or pipe stem are required order items 62, 63 and 64.
- (i) Not available for 1931 & prior models — See note (e).
- (j) Order item 45 also.
- (k) Order bearing Stop Ring, item 20, also.

Ref. No.	Part Number	Previous Part No.	Used On & No. Used			Description
			Prior to Late '31	Late 1931 to June '52	June '52 & Later	
35	380 3 0150		1	1	1	Packing for Hood
36	380 2 0030	001301	(a)	1(g)	1(g)	Main Frame (1) 907 00036 1/2" Pipe Plug, Black
37	380 3 0127	1318A	N.A.	1	1	Brake Lever (5) 900 10071 21/32" ID x 1-1/4" OD x 16 Ga. Washer (1) 900 22013 5/32" x 1" Cotter Pin
38	380 2 0036		1	1	1	Brake Rod Assembly — Consists of Items 39 through 42 (1) 380 3 0023 3/8" x 1-5/8" Drilled Rivet (1) 900 22013 5/32" x 1" Cotter Pin
39	380 3 0118	01332	1	1	1	Brake Rod
40	380 3 0021	1533	1	1	1	Brake Rod Clevis
41	380 3 0022	1595	1	1	1	Brake Rod Spring
42	380 2 0183	1531	1	1	1	Brake Rod Guide Washer
43	380 3 0045	1280	1	1	1	Regulating Spring Arm (1) 900 00018 3/8" NC x 1-1/4" Hex Head Bolt (1) 900 05011 3/8" NC Hex Nut (1) 900 10030 3/8" Lockwasher
44	380 3 0063	1663H	1	1	1	Regulating Spring
45	380 3 0124	01312	1	1	1	Vane Hinge Pin (for Welded Vane Stem) (1) 900 00114 3/8" NC x 1-1/2" Hex Head Bolt, Plated (1) 900 10025 3/8" Lockwasher, Plated (1) 900 05012 3/8" NC Hex Nut, Plated (1) 900 10006 1/2" Flat Washer (1) 900 10029 1/2" Lockwasher (1) 900 05042 1/2" NC Hex Nut
46	380 2 0044		1	1	1	Bumper Assembly Consists of Items 47 through 49 (1) 900 00112 3/8" NC x 1" Hex Head Bolt, Plated (1) 900 05012 3/8" NC Hex Nut, Plated (1) 900 10025 3/8" Lockwasher, Plated
47	380 3 0140	1216	1	1	1	Bumper Arm
48	380 3 0142	1269	2	2	2	Bumper Spring
49	380 2 0043	1284	1	1	1	Bumper Rod (1) 900 05020 1/2" NC Hex Nut (2) 380 3 0141 Bumper Spring Washer
50	380 3 0125	1207	1	1	1	Pullout Arm
51	380 3 0010	1209	1	1	1	Chain Sheave (1) 900 22013 5/32" x 1" Cotter Pin (2) 900 10050 9/16" ID x 1-1/8" OD x 12 Ga. Washer
52	380 3 0019	01308	N.A.	1	1	Chain Sheave Guard
53	380 3 0011	1224	1	1	1	Chain Roller (1) 101 3 1029 3/8" x 2-1/2" Oval Head Rivet (1) 900 22013 5/16" x 1" Cotter Pin
54	380 3 0109	01327	Sub.	1	1	Pipe Stem Clamp (2) 900 00077 5/8" NC x 4-1/2" Hex Head Bolt (4) 900 05023 5/8" NC Hex Nuts
55	380 3 0069	01255	(c)	1	1	Upper Ball Race
56	907 02003	15	15	15	15	Steel Balls — 5/8" Diameter
57	380 3 0070	01286	(c)	1	1	Lower Ball Race
58	380 3 0105	1257	1	1	1	Bed Plate (4) 900 00049 1/2" NC x 2" Hex Head Bolt (4) 900 05020 1/2" NC Hex Nut
59	380 3 0068	1094	4	4	4	Inside Corner Washer
60	380 2 0028	001382	(d)	1	1	Pullout Tube Assembly
61	380 3 0111	0102	1	1	1	Pullout Tube Chain Only — 20" (1) 903 02009 Open Link
62	380 2 0002	1378	(d)	1	1	Pipe Stem Assembly
63	380 2 0023	01366A	(e)	1	1	Pullout Swivel Assembly
64	380 3 0065	01366A	(e)	1	1	Pullout Swivel — Wire Side (3) 900 00009 5/16" NC x 1-1/4" Hex Head Bolt (3) 900 10023 5/16" Lockwasher (3) 900 05008 5/16" NC Hex Nut
65	380 3 0067	1-109	Sub.	Sub.	4	Outside Corner Washers
66	380 3 0106	580	1	1	1	Stop Stay (4) 900 00022 3/8" NC x 2-1/8" Hex Head Bolt (4) 900 10004 3/8" Flat Washer (4) 900 10025 3/8" Lockwasher (4) 900 05012 3/8" Hex Nut, Plated
67	380 3 0033	1279H	2	2	2	Pipe Stem Clamp (2) 900 00023 3/8" NC x 2-1/2" Hex Head Bolt (4) 900 05011 3/8" NC Hex Nut