

Old Type Baker Direct Stroke Mills

Windmill-Parts.com

Windmill-Parts.com

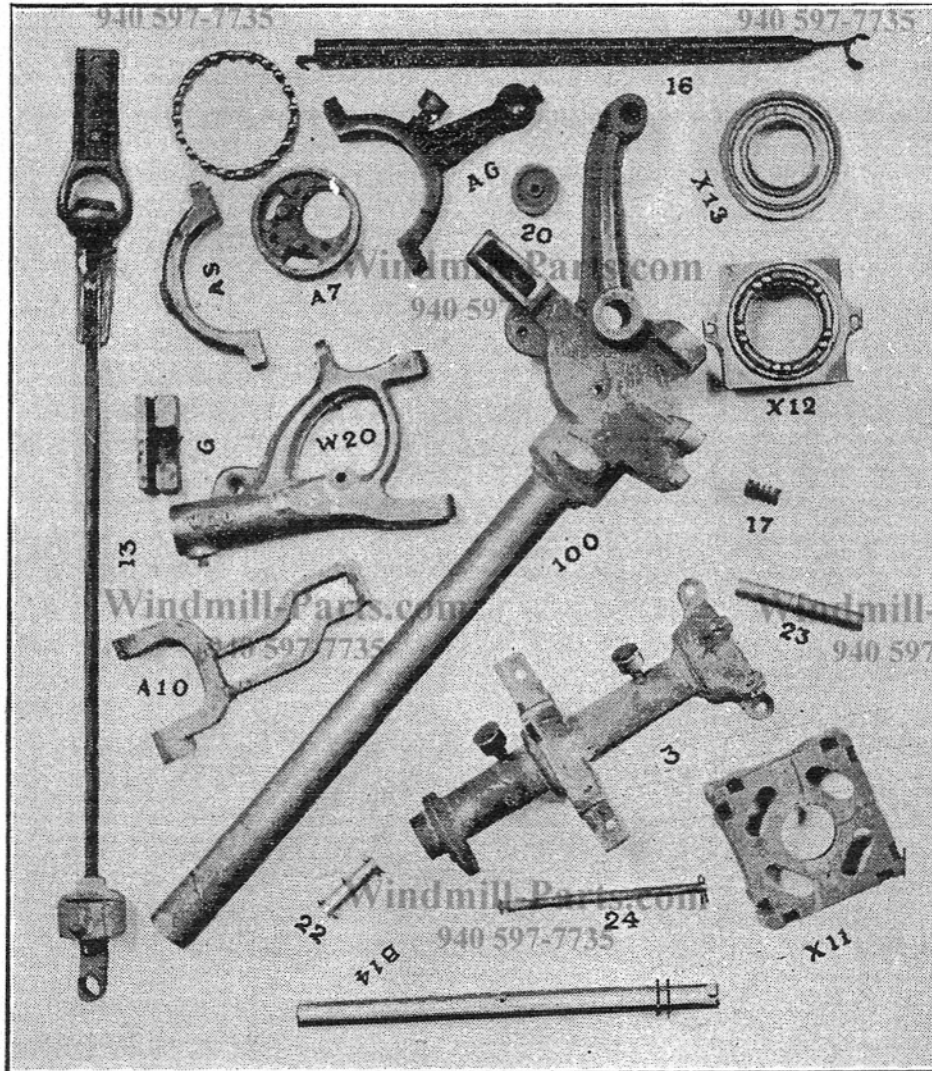

IMPORTANT: A single row ball bearing eccentric with crooked shank was used on Baker Mills before 1915 at which time they were supplanted with the double row ball bearing eccentric with straight shank. Prior to the single row ball bearing eccentric a slide eccentric was used.

**WHEN ORDERING REPAIRS GIVE SIZE OF MILL AND WHETHER
A SINGLE ROW BALL BEARING OR DOUBLE ROW STYLE**

**STATE PLAINLY THE NUMBER ON PART AND
DESCRIPTION OF PART**

940 597-7735

Repair Price List

Windmill-Parts.com OLD-OPEN STYLE DIRECT STROKE BAKER WINDMILL
 940 597-7735 Windmill-Parts.com 940 597-7735

8-FOOT AND 10-FOOT

Number		Description of Part	Price	
8-Foot Size	10-Foot Size		8-Foot Size	10-Foot Size
.....	Double Row Ball Bearing Eccentric, complete.....	\$6.00	\$6.00
A100	100	Main Casting.....	6.50	8.50
F2	W20	Vane Casting.....	2.50	3.50
A3	3	Wheel Hub.....	5.00	5.50
A6	A6	Upper Part of Double Ball Eccentric Ring.....	2.50	2.50
A7	A7	Cam for Double Ball Eccentric.....	2.00	2.00
A8	A8	Lower Part of Double Ball Eccentric Ring.....	2.50	2.50
A10	A10	Rocker Arm for Double Ball Eccentric.....	3.50	3.50
X11	X11	Truing Center.....	1.25	1.25
X12	X12	Bottom Part of Turntable.....	1.38	1.38
X13	X13	Top Part of Turntable.....	.88	.88
X1213	X1213	Turntable, complete.....	2.25	2.25
A14	B14	Steel Spindle.....	2.00	2.50
13	13	Steel Pump Rod and Swivel.....	4.50	4.50
A16	16	Regulating Spring.....	1.40	1.50
A17	17	Spring Bumper.....	.40	.40
19	19	Pull Out Chain.....	.50	.50
20	20	Pulley for Pull Out Chain.....	.50	.50
22	22	Short Steel Pin for Rocker Arm.....	.50	.50
23	23	Long Steel Pin for Rocker Arm.....	.50	.50
A24	24	Steel Pin for Vane Casting.....	.60	.60
.....	Short Rim for Wheel.....	1.10	1.50
.....	Long Rim for Wheel.....	1.50	2.00
.....	Large Steel Sail Chair.....	.15	.15
.....	Small Steel Sail Chair.....	.10	.10
.....	Wheel Fan or Sail.....	.25	.25
.....	Flat Steel Wheel Arm.....	.80	1.00
.....	Angle Steel Brace for Wheel.....	.50	.60
.....	Vane Stem or Pipe.....	2.30	3.00
.....	Supporting Rod for Vane.....	.90	1.00
.....	Wheel Complete with Arms and Braces and Bolts.....	25.00	28.00
.....	Vane, complete.....	9.50	11.00
.....	Engine, complete.....	17.50	21.00
.....	Ball Bearings and Retainers for D. B. Eccentric.....	2.00	2.00
.....	Ball Retainers only for Double Ball Eccentric, per set of 2.....	.40	.40

SINGLE ROW BALL BEARING ECCENTRIC

Number		Description of Part	Price	
8-Foot Size	10-Foot Size		8-Foot Size	10-Foot Size
6	6	Upper Part Single Ball Eccentric Ring.....	\$1.40	\$1.40
7	7	Cam for Single Row Ball Eccentric.....	1.40	1.40
8	8	Lower Part of Single Row Ball Eccentric.....	1.40	1.40
10	10	Rocker Arm for Single Row Ball Eccentric.....	3.50	3.50
.....	Single Row Ball Eccentric complete with Bolts.....	4.00	4.00
.....	Set of Ball Bearings for Single Ball Eccentric.....	1.00	1.00

WHEN ORDERING GIVE SIZE OF MILL AND WHEN ERECTED

STATE PLAINLY THE NUMBER ON PART
 AND DESCRIPTION OF PART
 940 597-7735